

Product Overview

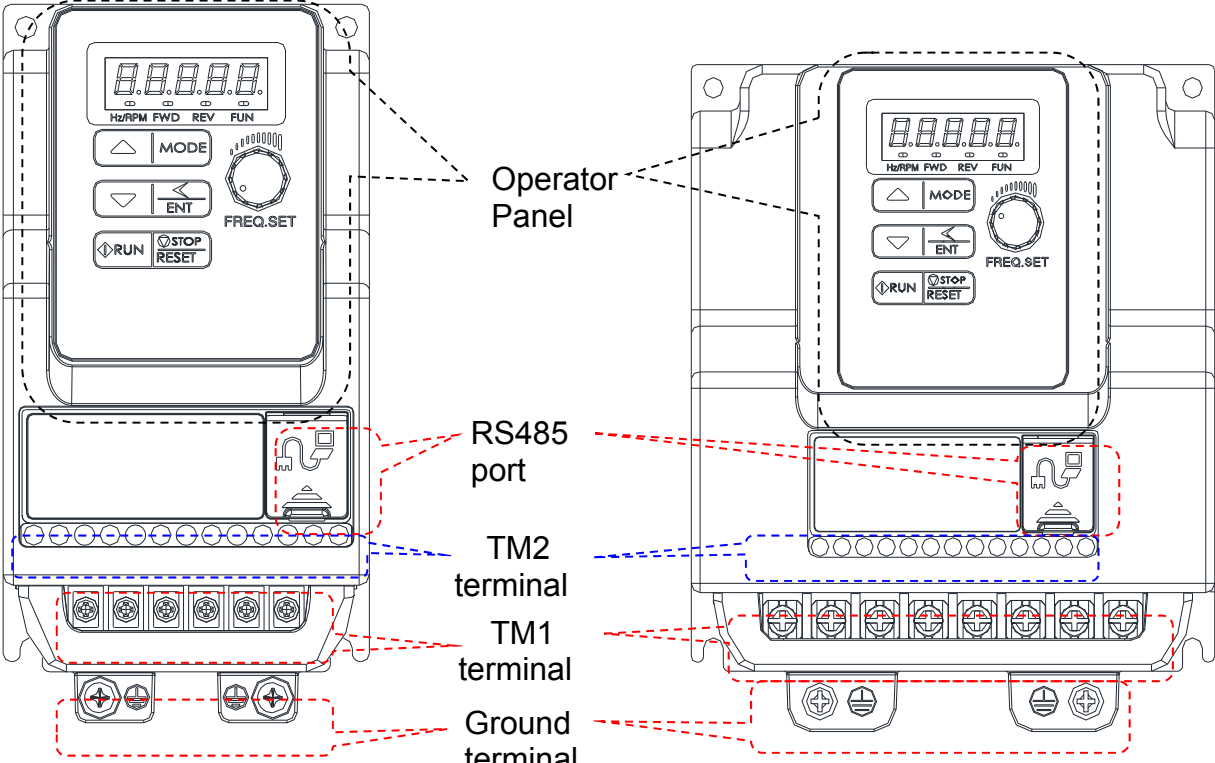

Frame 1

Frame 2

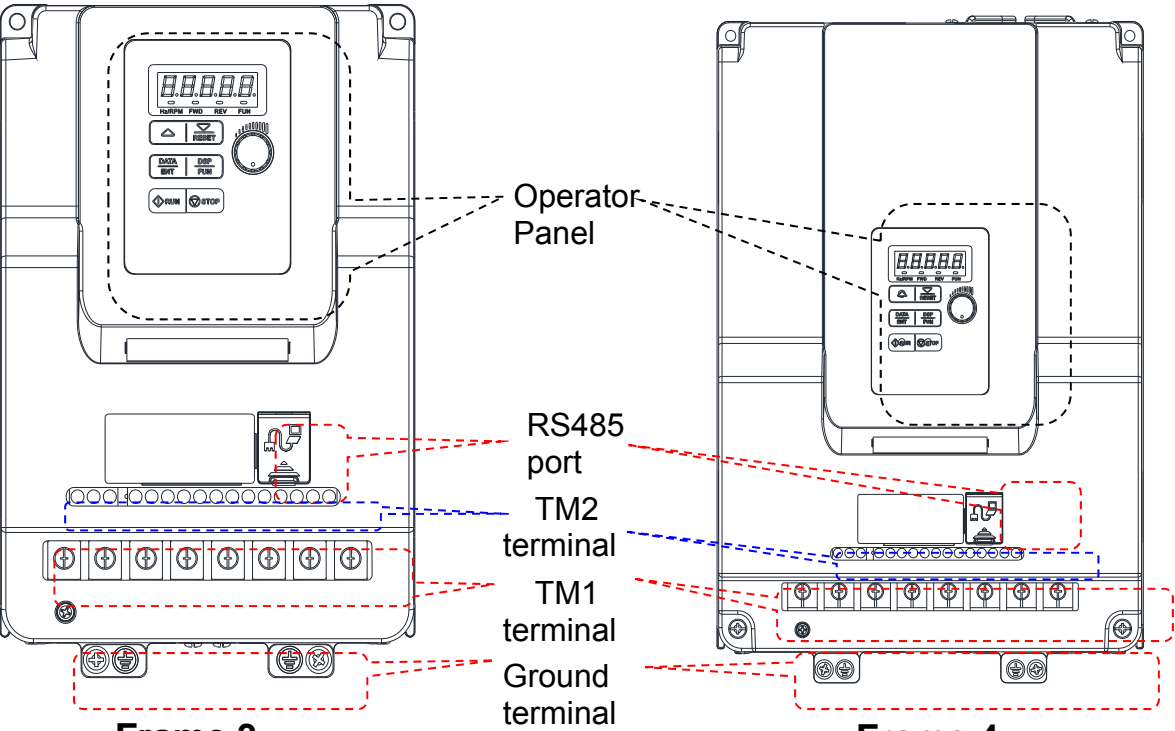

Frame 3

Frame 4

3.2 Installation

3.2.1 Installation methods

Frame1. Mounting on a flat surface.

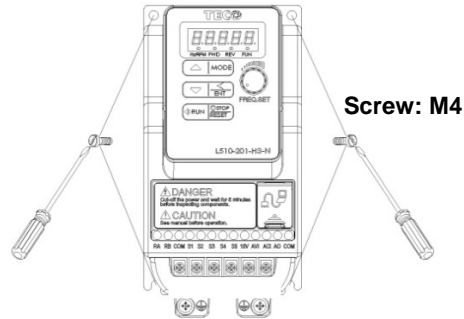

Din rail type installation:

Din rail kit includes a plastic and a metal adaptor plates.

Assembly Steps:-

- 1) Attach the metal adaptor plate to the inverter base with the screws provided.
- 2) Attach the plastic Din rail adaptor to the metal adaptor plate.
- 3) Push the plastic adaptor forward to lock into position.

Disassembly Steps:-

- 1) Unlock by pushing the snap hooks
- 2) Retract and remove the plastic Din rail adaptor.
- 3) Unscrew the metal plate & Remove

Assembly:-

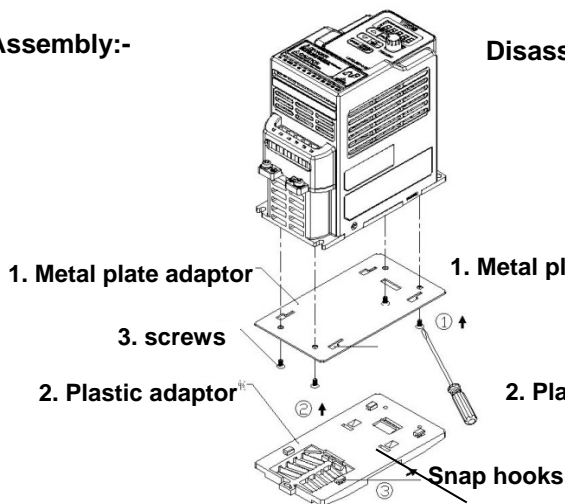

Disassembly:-

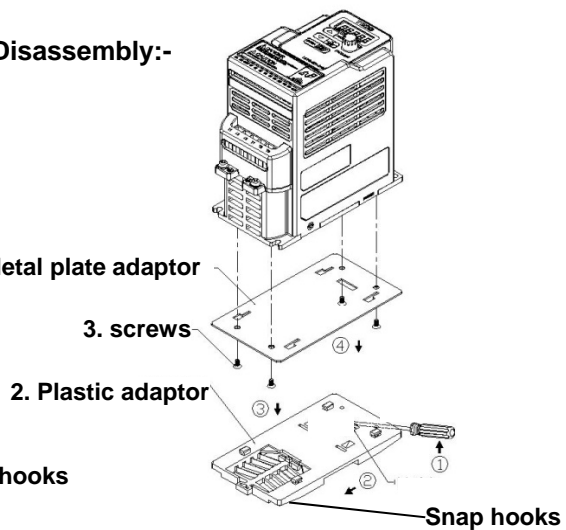

Note:

JN5-DIN-L01 (Frame 1 Din rail kit part number), including the following parts

1. Metal plate adaptor
2. Plastic adaptor
3. Chamfer head screw: M3x6

Frame 2. Mounting on a flat surface.

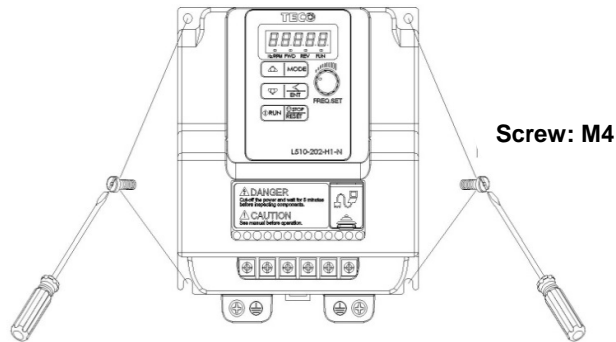

Din rail type installation:

Din rail kit includes a plastic adaptor plate as an attachment for the inverter base. Refer to Diagram below:-

Assembly:-

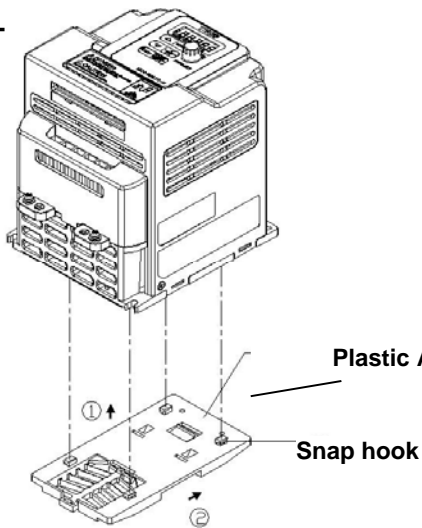

Disassembly:-

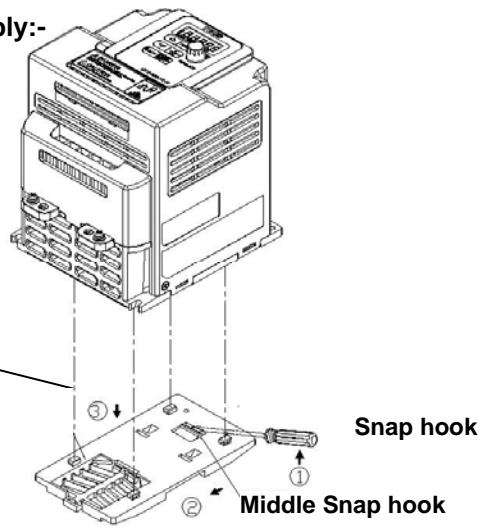

Din Rail Mounting & Dismounting as shown in the diagram below:-Use a 35mm Din Rail.

Mounting

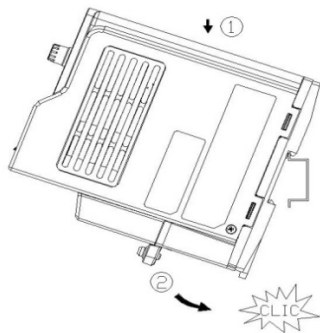

Dismounting

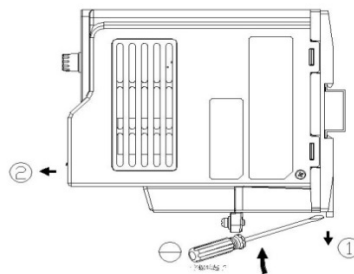

Plastic adaptor plate.
JN5-DIN-L02 (Frame 2 Din rail kit part number)

Frame 3. Mounting on a flat surface

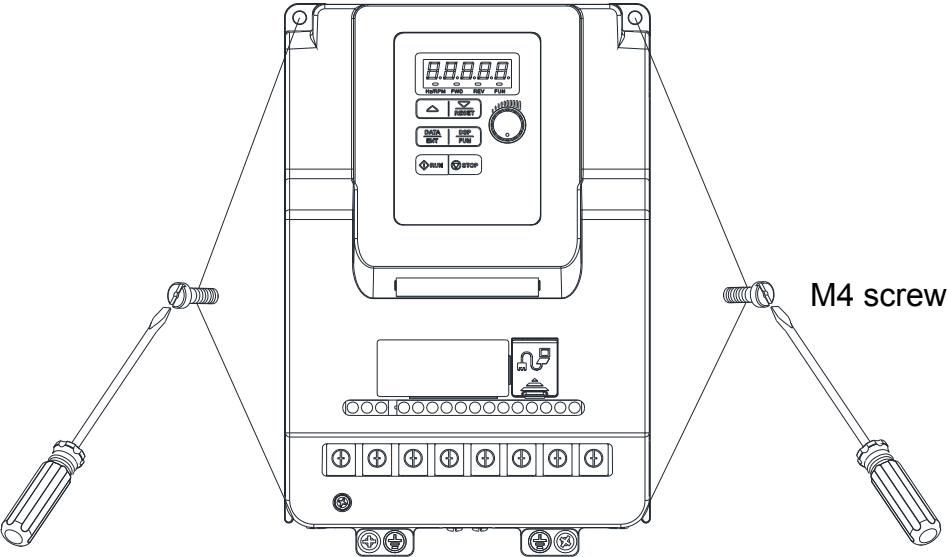

Frame 4. Mounting on a flat surface

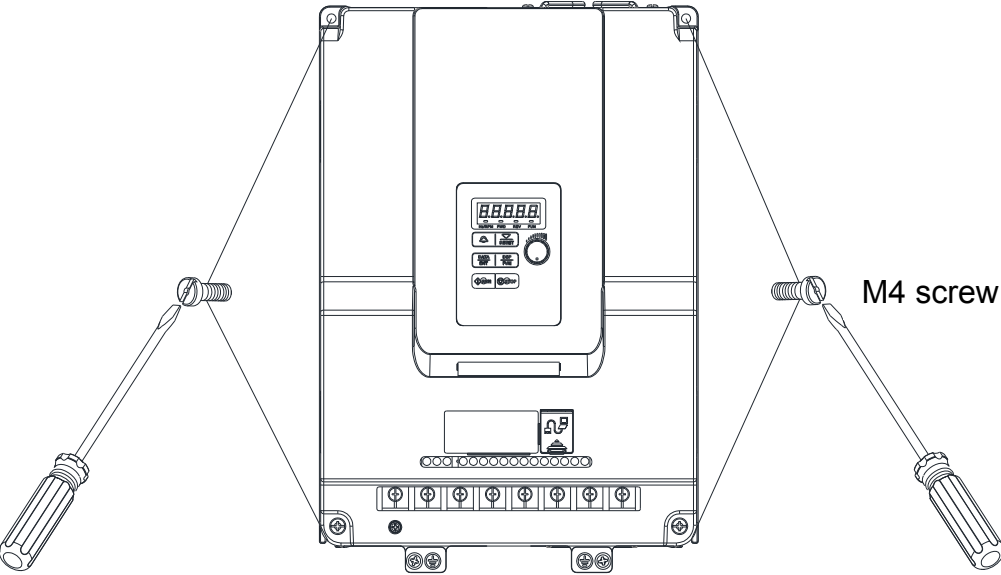

3.2.2 Installation space

Provide sufficient air circulation space for cooling as shown in examples below. Install the Inverter on surfaces that provide good heat dissipation.

Single unit Installation

Install the inverter vertically to obtain effective cooling.

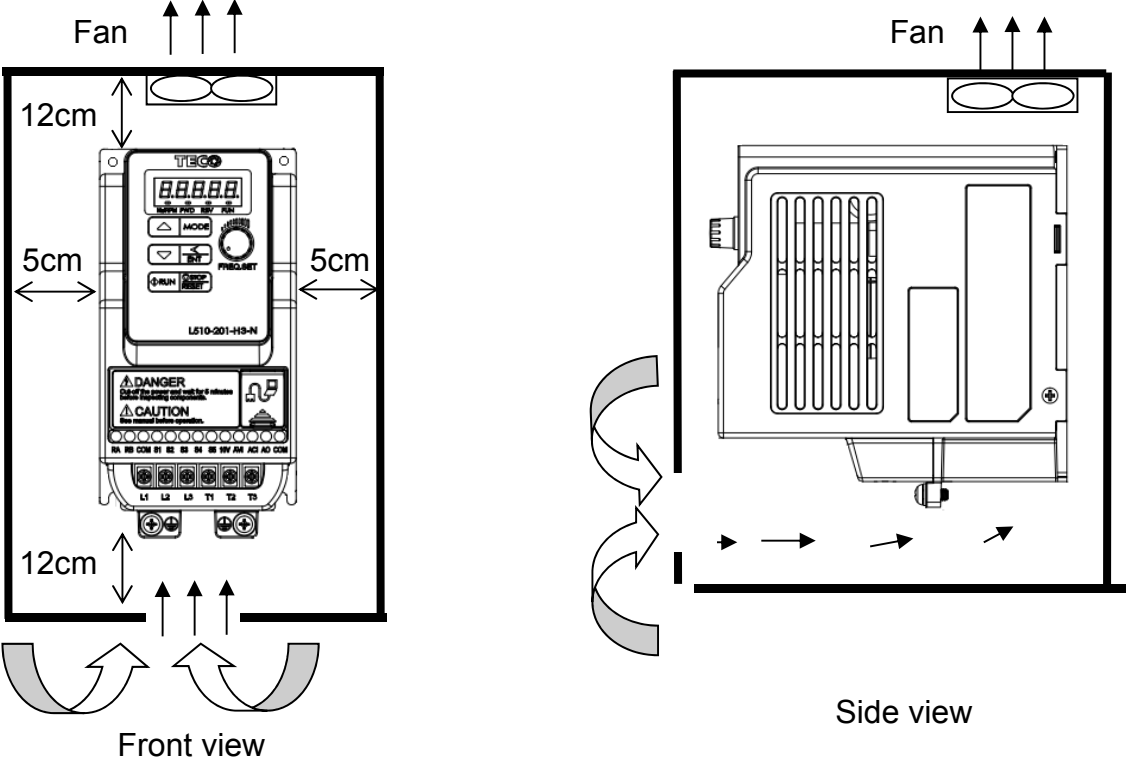

Side by side Installation

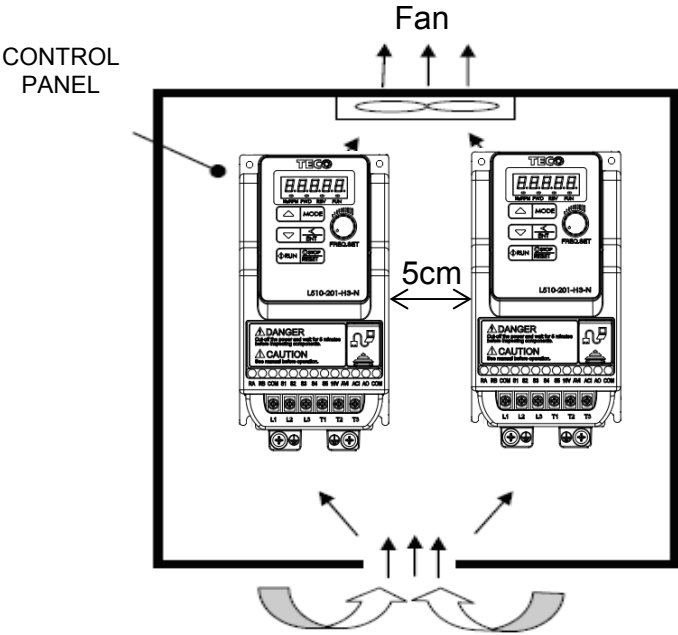

Provide the necessary physical space and cooling based on the ambient temperature and the heat loss in the panel

Installation for Grounding kit

Grounding kit :

As bellowed diagram, use screw to install EMC metal plate into heatsink.

Frame 1

Frame 2

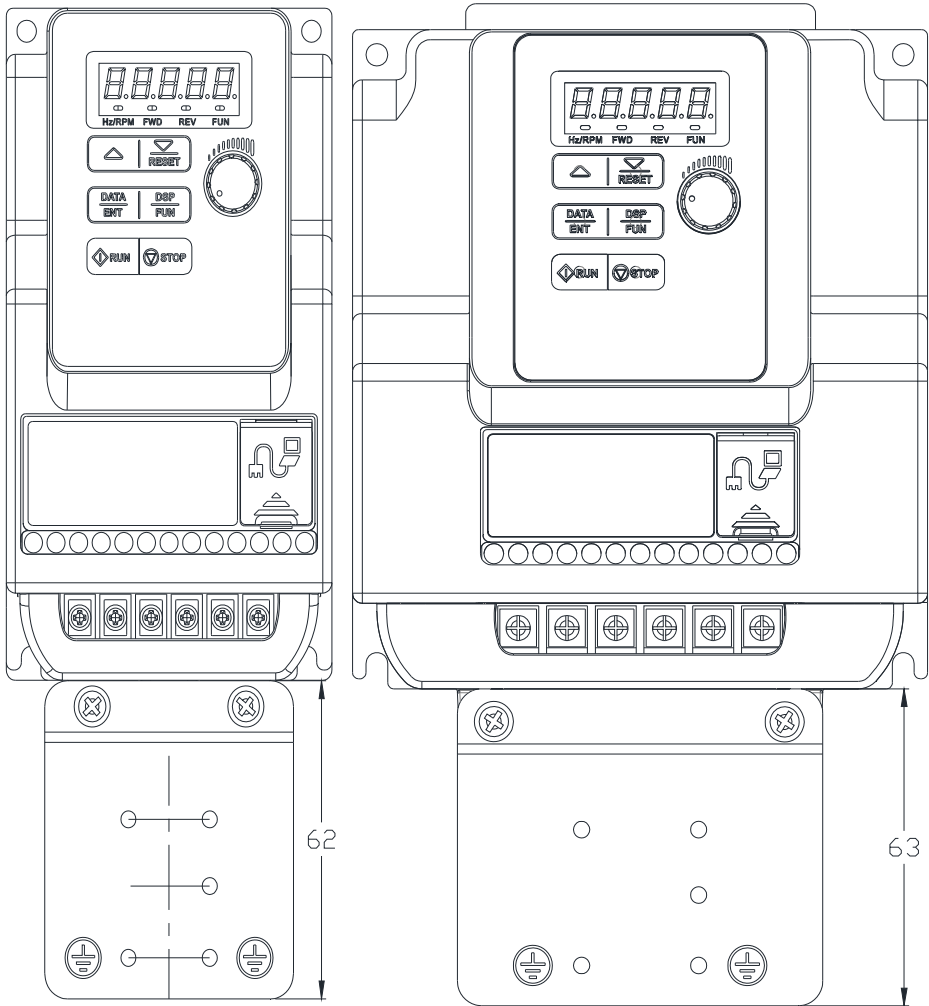

Grounding kit option installation diagram and instruction (Example)

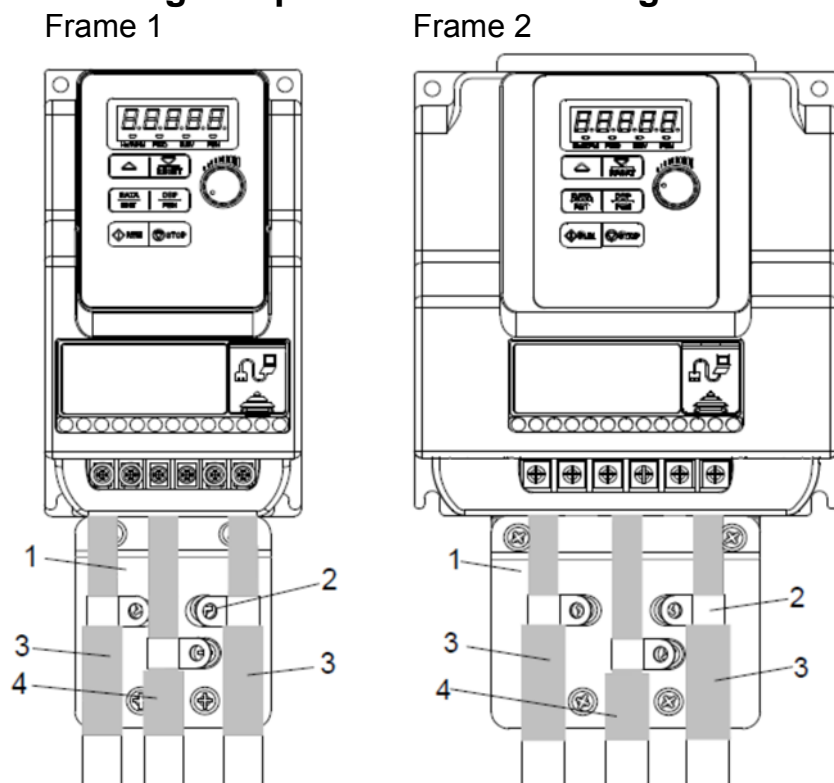

1. Grounding kit to be mounted on the drive (earth casing), please follow the diagram to install .
2. Unshielded power supply lines or cable.
3. Unshielded wires or cable for the output of the relay contacts.
4. Attach and earth the shielding of cables **3** and **4** as close as possible to the drive:
 - Strip the cable to expose the shielding;
 - Attach the cable to the plate **1**, attaching the clamp on the stripped part of the shielding.

The shielding must clamped tightly enough to metal sheet to ensure good contact.
5. Shielded power supply cable for connecting motor which connect to earth at both ends. The shielding must be continuous, and if intermediate terminals are used, they must be placed in EMC shielded metal boxes.
6. Shielded cable for control-signal wiring. For applications requiring several conductors, use cables with small cross-section (0.5 mm², 20 AWG). For cables **3** and **4**, the shielding must be connected to earth at both ends. The shielding must be continuous, and if intermediate terminals are used, they must be placed in EMC shielded metal boxes.

Notice :

- If using external EMC input filter, it must be mounted under the drive and connected directly to the line supply via an unshielded cable. Link **6** on the drive is then via the output cable.
- The HF equipotential earth connection between the drive, motor and cable shielding does not remove the need to connect the PE conductors  (green-yellow) to the appropriate terminals on each device.